

# BT1-Bluetooth (For iOS)

## Bluetooth Standalone Access Control

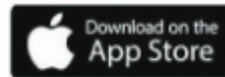
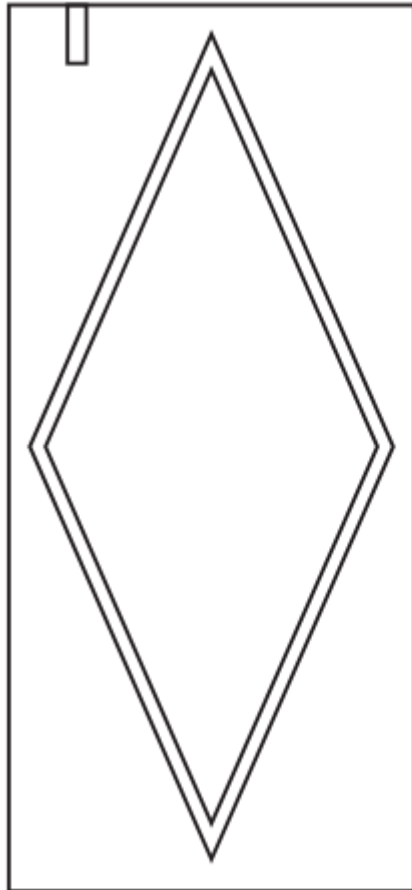

**User Manual**

[www.holars.se](http://www.holars.se) – [www.holars.no](http://www.holars.no)

# Introduction

The BT1-Bluetooth is a metal case anti-vandal standalone access control that can be mounted both indoor and outdoor. The unique feature is it can be operated by mobile phone through Bluetooth or 13.56MHz Mifare or 125KHz EM Card. The operation is very smart and convenient.

## Two versions optional:

IC Version:13.56MHz Mifare Card <---- **Standard modell.**

ID Version:125KHz EM Card

## Features:

- Vandal resistance enclosure
- Waterproof, conform to IP66
- One programming relay output
- 10,000 users (including Mifare and mobile phone user)
- Two ways to open the door: Mifare Mobile phone.
- Support opening the door through Bluetooth(version: 4.0 above), APP supports iOS7.0 above
- Support sending Remote E-key to others (the Administrator can control access time)
- Latch mode to hold door or gate open
- Multi-color LED status display

## Specification:

<b>User Capacity</b> Card Mobile	<b>10,000</b> 13.56MHz Mifare Card IOS7.0 above
<b>Operating Voltage</b> Idle current Active current	<b>12V DC</b> ≤35mA ≤90mA
<b>Proximity Card Reader</b> Radio Technology Card Read range	<b>Mifare Card</b> 13.56MHz 2~6cm
<b>Bluetooth</b> <b>Range</b> <b>Reaction</b>	<b>Bluetooth Version:4.0 Above</b> <20m (relate to environment) <2seconds
<b>Relay</b> Lock Output Load	<b>One(NO, NC, COM)</b> 2 Amp Maximum
<b>Environment</b> Operating Temperature Operating Humidity	<b>Meets IP66</b> -20°C~+60°C 0%~98%

<b>Physical</b>	Zinc-Alloy Enclosure
Dimension	L103 X W48 X H19 (mm)
Net Weight	260g
Shipment Weight	300g

### Carton Inventory

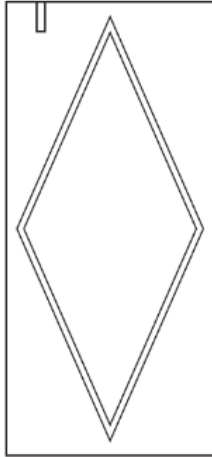

Self Tapping Screws



Wall Anchors



Screw Driver



Diode 1N4004 (For relay circuit protection)

## Installation

- Drill 2 holes(A,C) on the wall for the screws and one hole for the cable, thread the cable through the cable hole(B)
- Knock the rubber bungs to the screw holes(A,C), fix the back cover firmly on the wall with 4 flat head screws
- Attach the unit to the back cover.

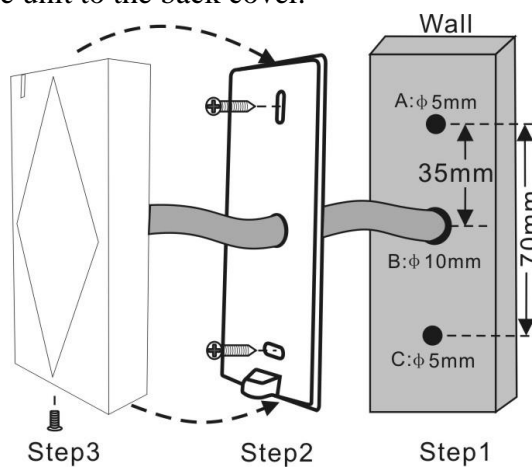

### Wiring

No.	Color	Function	Notes
-----	-------	----------	-------

1	Green	NC	Normally Closed Relay Output
2	Brown	COM	Common Connection for Relay Output
3	White	NO	Normally Open Relay output
4	Black	GND	Negative Pole
5	Red	+12V	Regulated Power Input
6	Yellow	OPEN	Request to Exit input(REX)

## Connection Diagram:

### Common Power Supply:

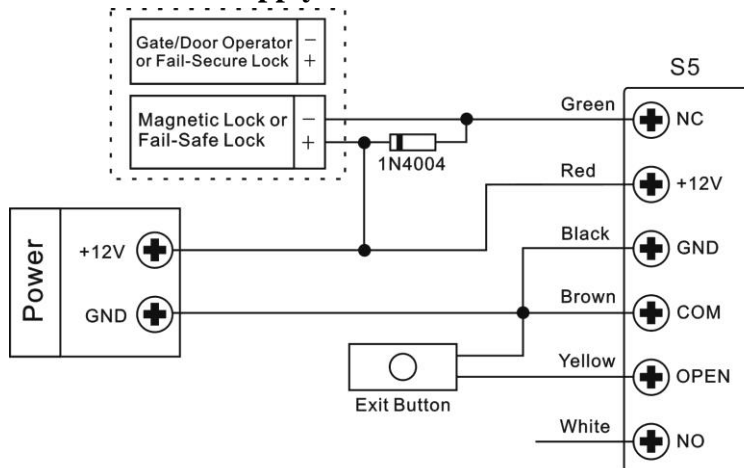

Attention: Install a 1N4004 or equivalent diode is needed when use a common power supply, or the reader might be damaged. (1N4004 is included in the packing)

### Access Control Power Supply:

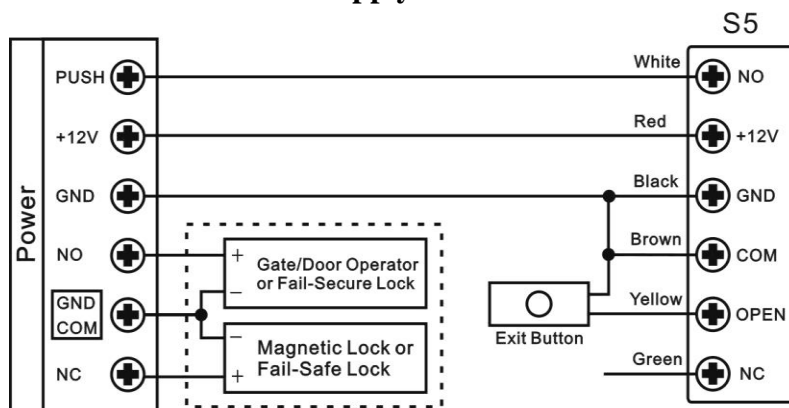

## APP Operation

Here are just a few steps to get you started:

- 1) Make sure your iPhone / iPad connects to the network, and the Bluetooth is turn on
- 2) Free download APP



(Searching doormaster)

## 1. Register

DoorMaster

Mobile or Email

PassWord

Login

Register

Forgot?

Register an account

Pic 01



< Back Register Mode

Only for China phone number

Phone Register

Email Register

Pic 02



< Register Mode Email Register

Please enter your email address

Email

Please create your login password

Password

Ensure Password

Please enter your nickname

Nickname

Register

Fill in all the blanks, then click Register

Pic 03

**You will get an email from DoorMaster**

Thank you for registering DoorMaster, please verify Email  
DoorMaster [admin@intelligoo.com]  
收件人: xalex1@xseukey.com.cn

hi Jason,

Thank you for registering DoorMaster, please click on the following link to verify your Email:

<https://www.doomaster.me/9099/account/verifyemail?code=F8D523ACCA92D894FAA0046DD66759CD>  
(if you can not click on the URL link address, copy it and paste it into your browser's address input box, and then click Enter. The link is more immediately after use.)  
Note: Please use the message is received within one hour, otherwise the link will be deactivated.

--  
DoorMaster

Click the Link to Finish Register

Pic 04

**Then Register Successfully.**

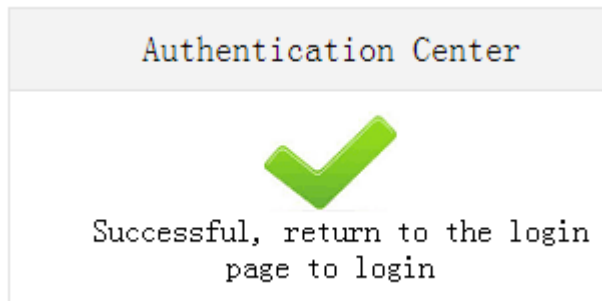

Pic 05

## 2. Add Device & Set Master Users

Below steps are only available for Masters. Each device has 1 Super Master and 10 Master Users (The 1<sup>st</sup> user to add device is the Super Master, the 2<sup>nd</sup>~11<sup>th</sup> users to add device are Master Users)

**. Login the App with your email address and password**

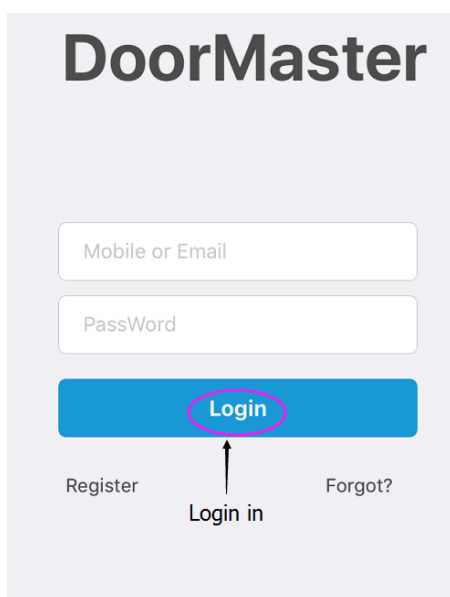

Pic 06-1

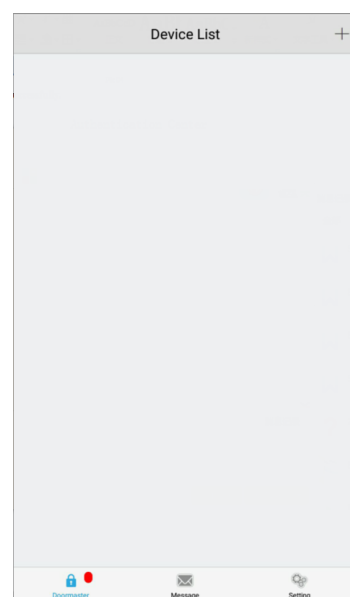
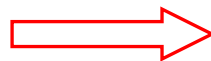

Pic 06-2

**. Slowly press exit button for three times, when Red light shines, operate like below:**

(Remark: If the Red light doesn't shine, it means the Super Master has been added, please erase all users firstly—refer to page14)

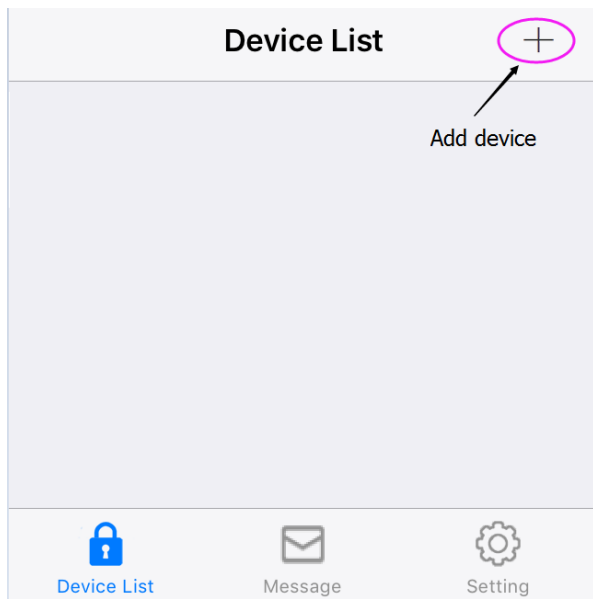

Pic 07

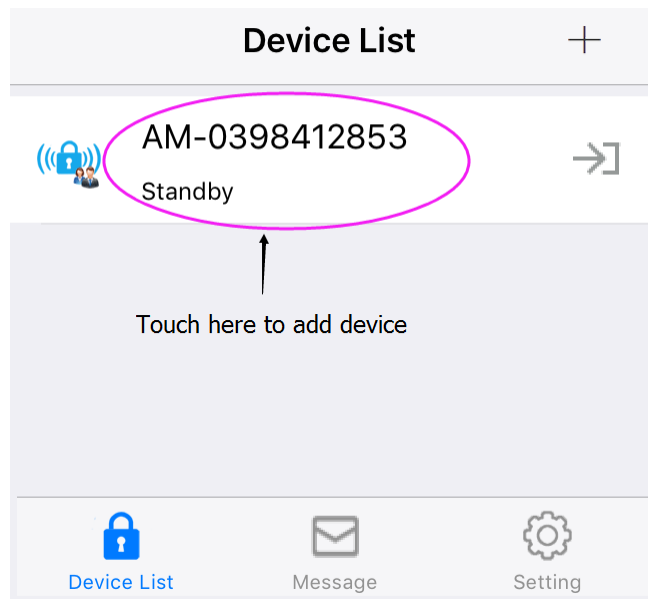

Pic 08

**. When hear one “Beep”, means add device successfully.**

(Remark: The Super Master and Masters should add device at one time, otherwise, the Super Master need to send E-Key to other users and set them as Masters---Refer to page 11)

### 3. Add Common Users

Register an account, then ask the Super Master or Masters send E-Key

**Below is Authority for Different Users**

Authority	Super Master User	Master Users	Common Users
Open Door	√	√	√
Change Device Name	√	×	×
Add Card	√	√	×
Delete Card	√	√	×
Send E-Key	√	√	×
Set Relay Configuration	√	×	×
Set Common Users as Master User	√	×	×

Press the key next to device name to enter configure setting menu (change device password setting is not valid for the moment).

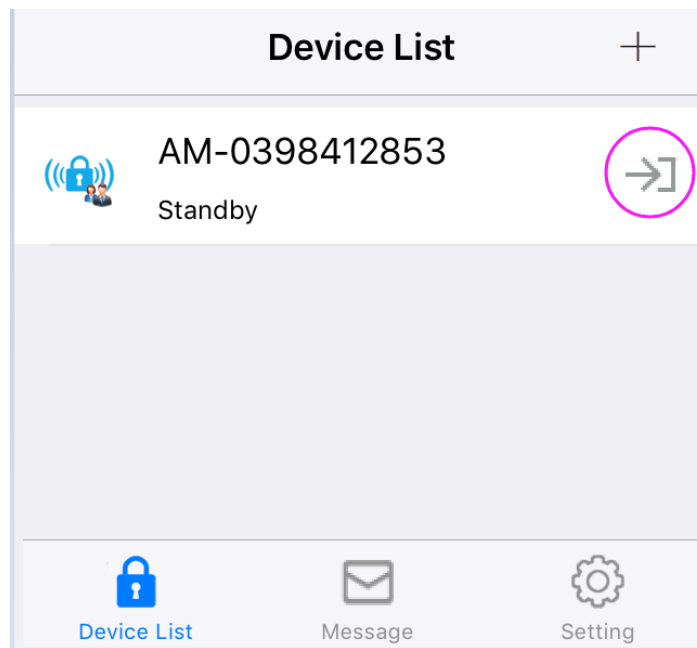

Pic 09

#### 4. Add and Delete Card Users by App

##### Add Card Users

When hear one “Beep”, the Red LED shines once per second, the APP shows “Punch Register”, click it, then read card on BT1 (Cards can be added continuously)

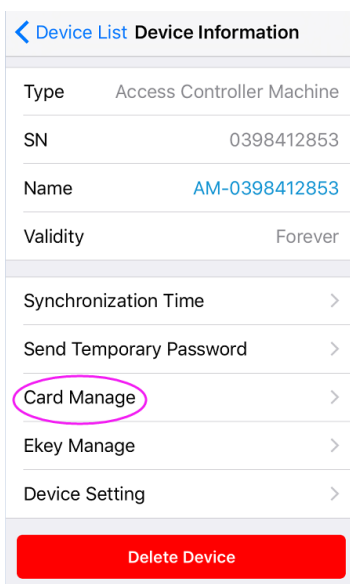

Pic 10

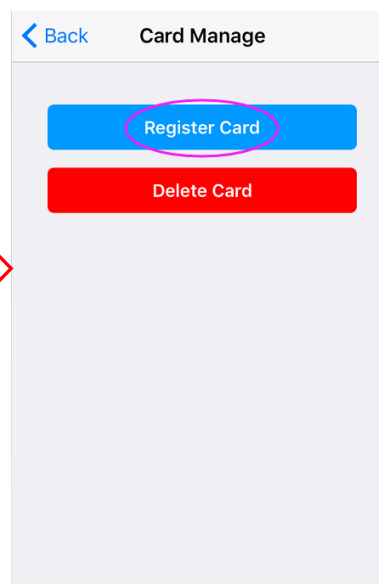

Pic 11

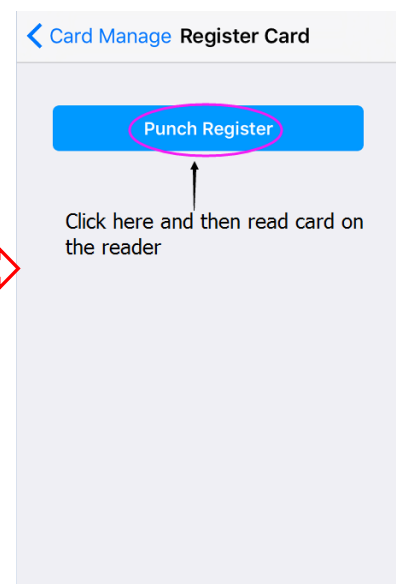

Pic 12

After one beep, it means the card is added successfully, press “Exit” to back to menu



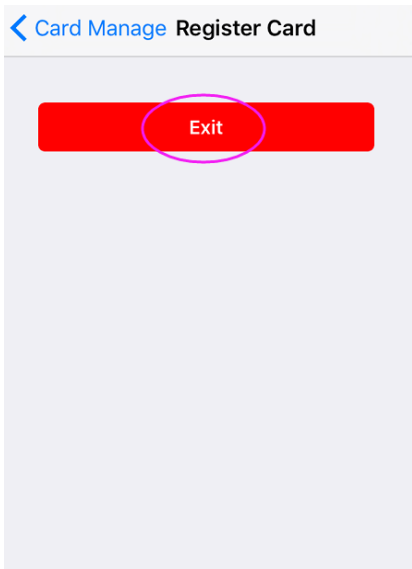

Pic 13

### Delete Card Users

When hear one “Beep”, the Red LED shines once per second, the APP shows “Punch Delete”, click it, then read card on BT1 (Cards can be deleted continuously), after one beep, it means the card is deleted successfully, press “Exit” to back to menu.

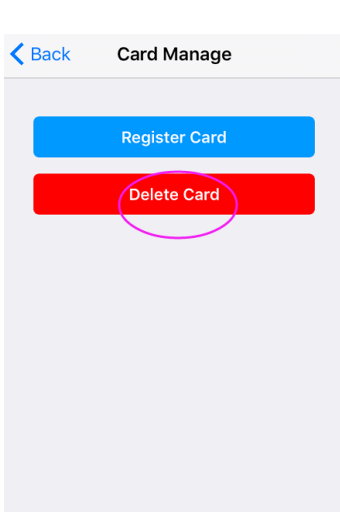

Pic 14

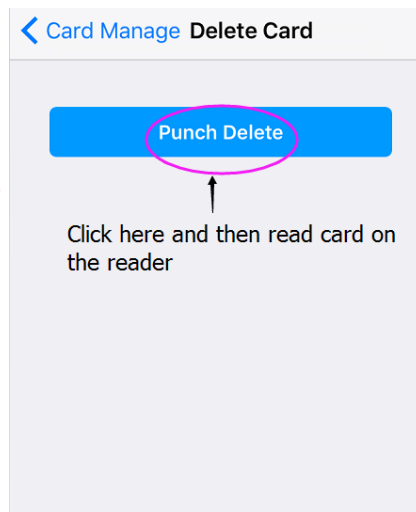

Pic 15

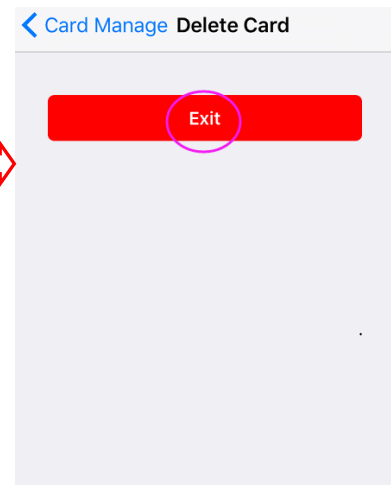

Pic 16

## 5. Set Relay Configuration

**Lock Control:** Set the door open time (Factory Default: 5 seconds)

**Manually Control:** Set the relay to ON/OFF mode (Latch mode)

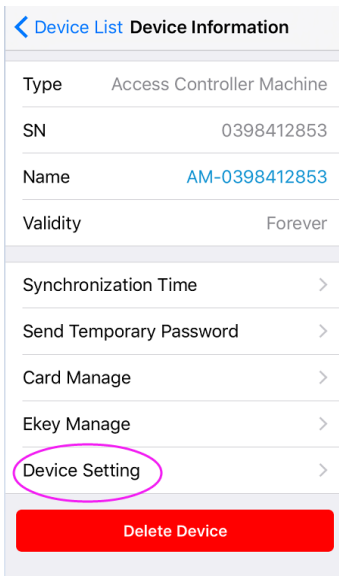

Pic 17

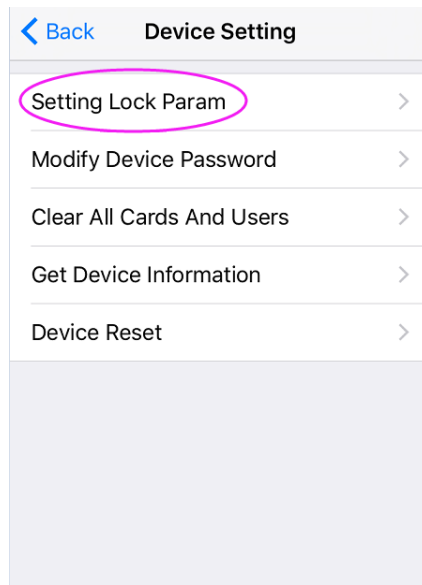

Pic 18

### Lock Control Mode

**OR**

### Manually Control Mode (Latch Mode)

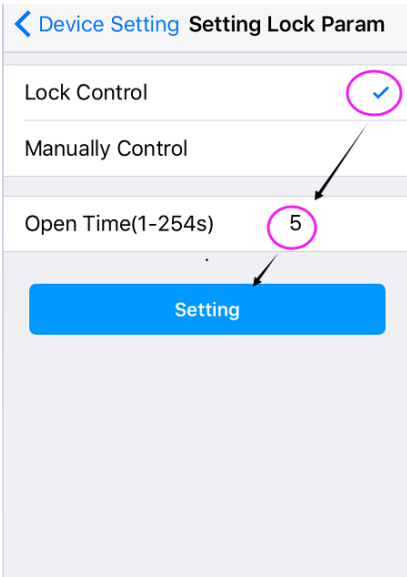

Pic 19

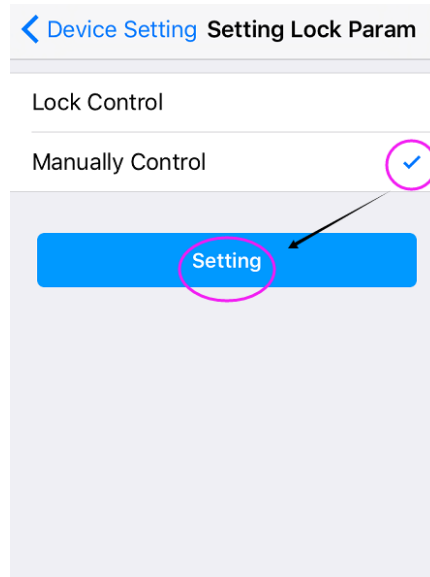

Pic 20

## 6. Open door

1. Read the valid user card
2. Open the door by “Shaking” your mobile (Remark: This function is valid only after login in App)  
(Factory default is OFF)  
Turn ON the “Shake open”: Login in >> Setting>>>Shake open ‘ON’

3. Open the door by App: login in the App, and touch the device to open the door

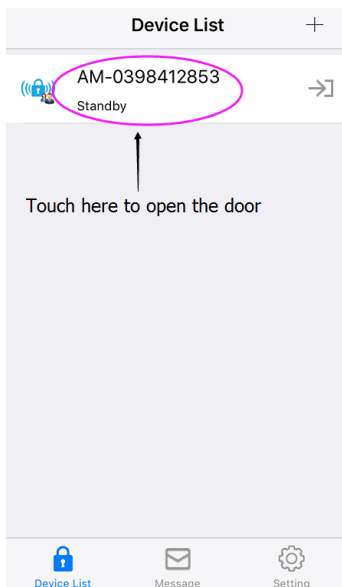

Pic 21

## 7. Send E-Key

**E-Key receivers can be set as Admin or Common User, and the authority can be Forever or Limited.**

(Remark: E-Key receivers must have registered in App firstly)

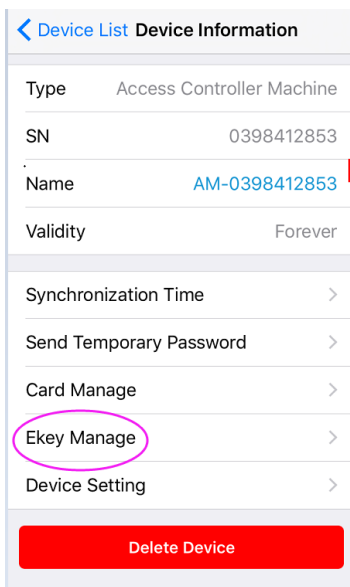

Pic 22

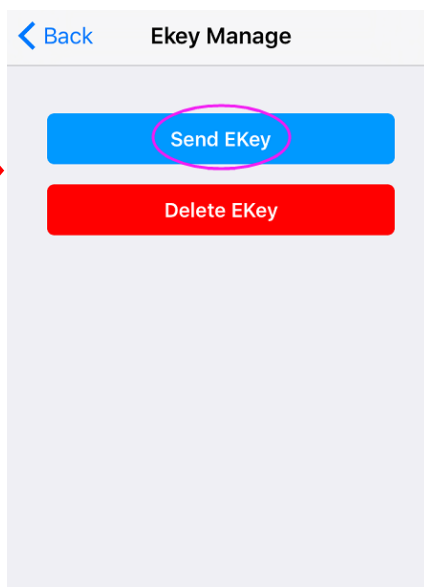

Pic 23

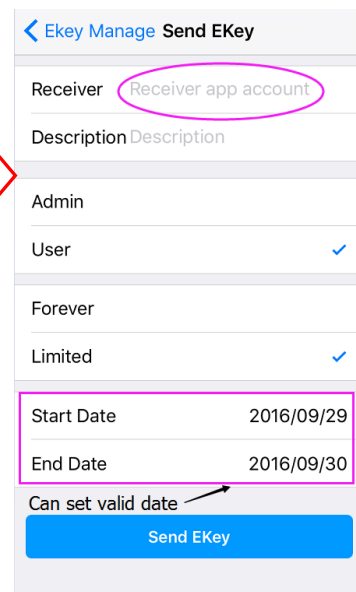

Pic 24

**The E-Key receiver will receive a message when log in.**

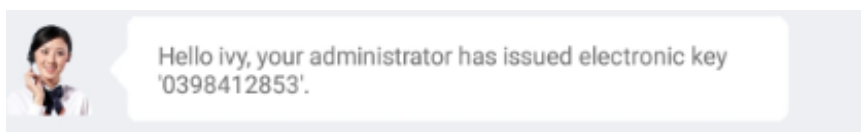

Pic 25

## 8. Delete E-Key

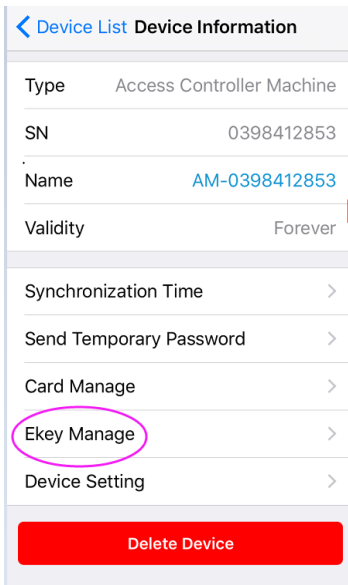

Pic 26

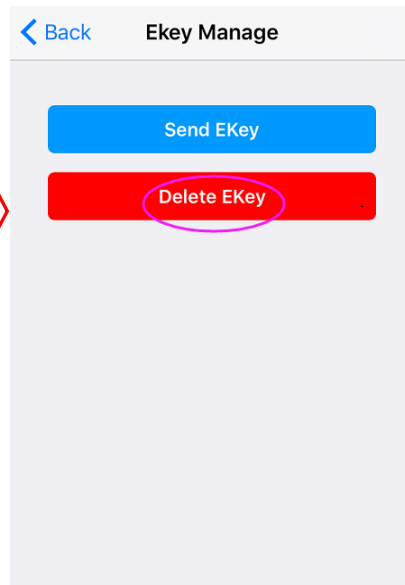

Pic 27

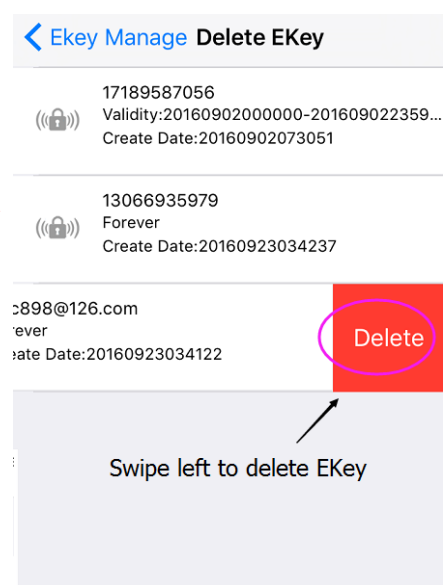

Pic 28

## 9. Modify Device Name

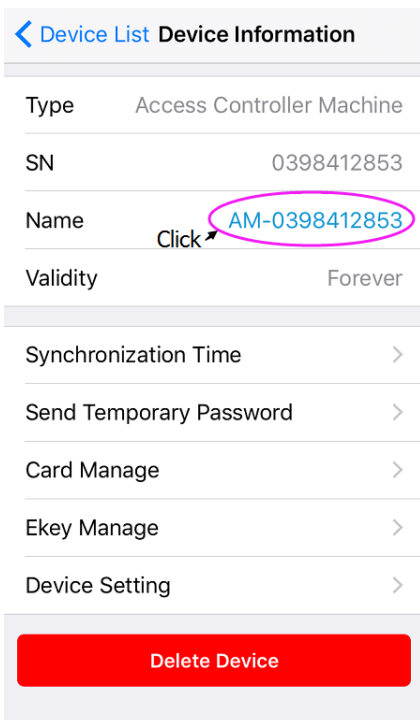

Pic 29

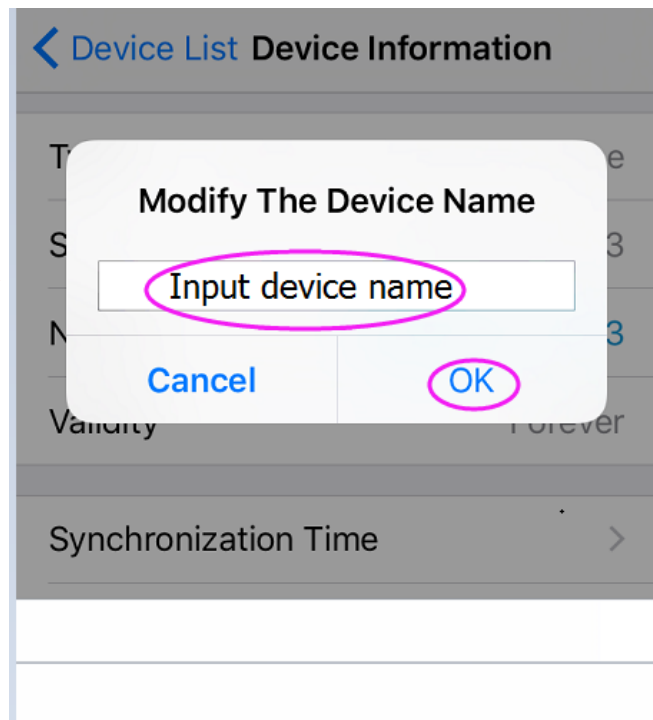

Pic 30

## 10. Modify Account Password

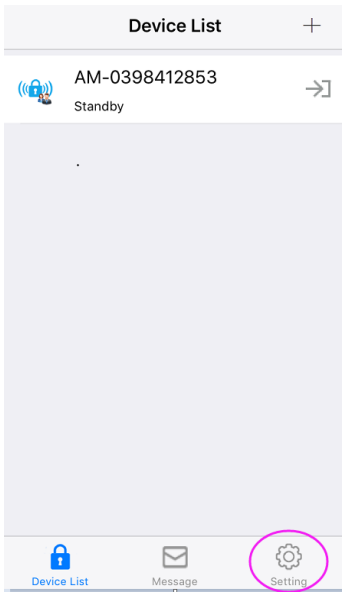

Pic 31

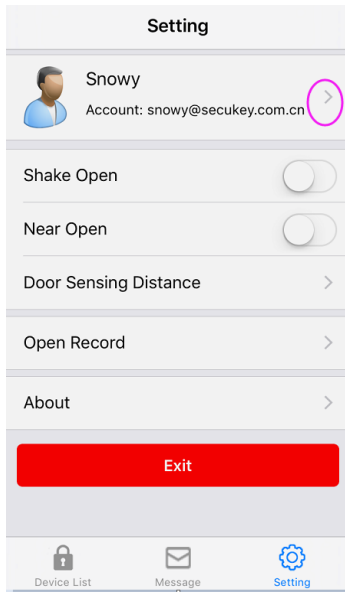

Pic32

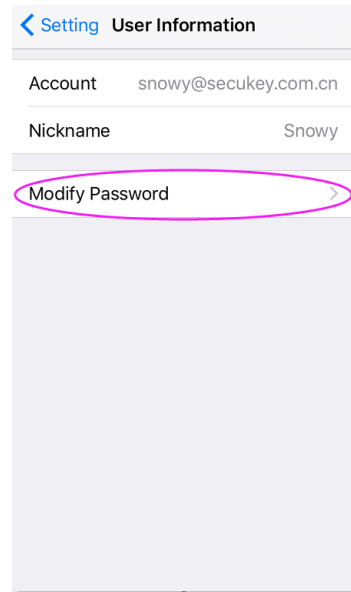

Pic 33

## 11. Device Reset (Method 1)

(Please refer to title OTHERS for Method 2)

This operation only reset the door open time to 5 seconds.

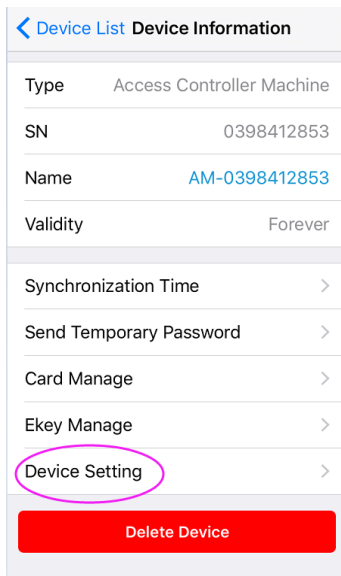

Pic34

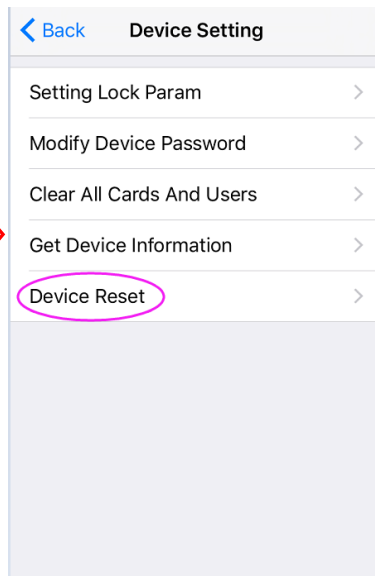

Pic 35

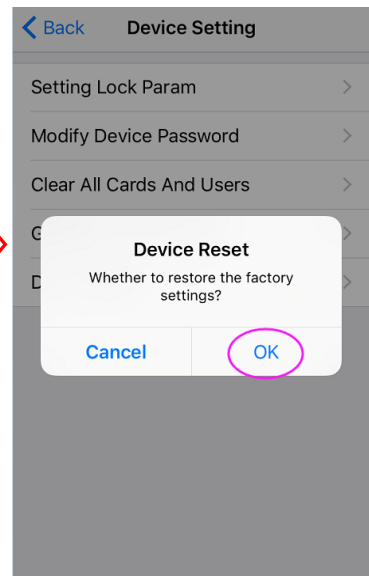

Pic 36

## 12. Erase ALL Users (Method 1)

(Please refer to title OTHERS for Method 2)

*Remark: This operation will be also reset the door open time to 5 seconds.*

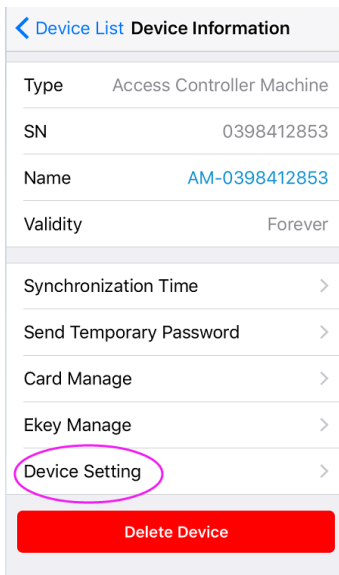

Pic 37

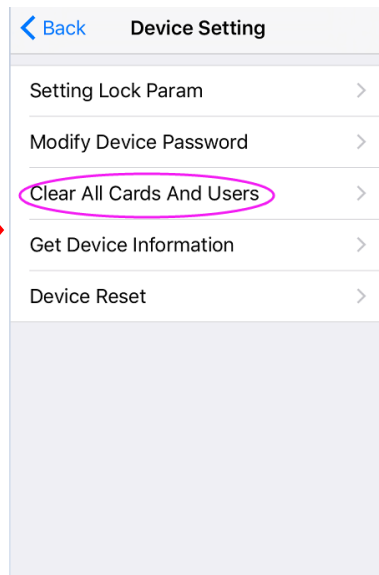

Pic 38

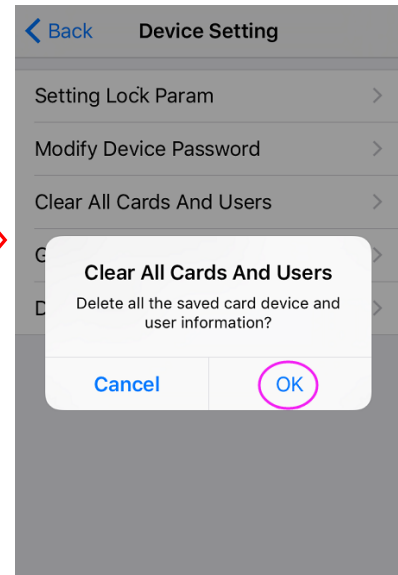

Pic 39

### 13. Delete Device

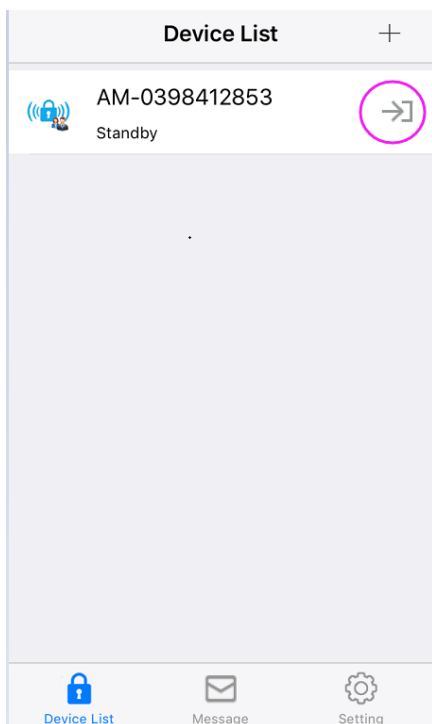

Pic 40

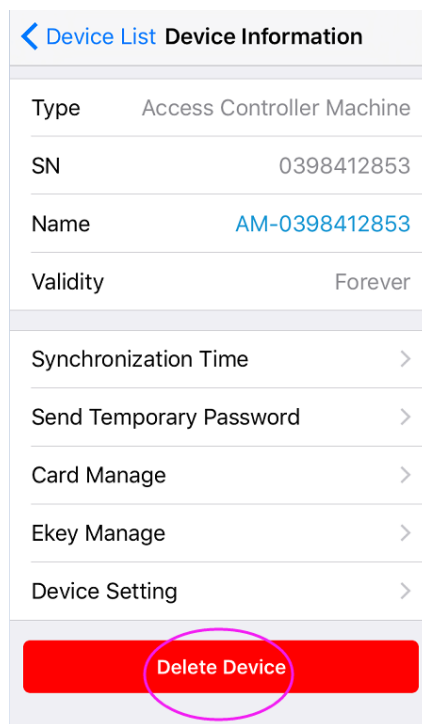

Pic 41

# OTHERS

---

## To Reset to Factory Default (Method 2)

To reset to factory default, power off and press exit button, hold it and power on (hold it for 10 seconds), release it until hear one beep and the LED in Red, means reset to default successfully.

**Remarks:** Reset to factory default, the users' information is still retained.

## Erase ALL Users (Method 2)

After resetting to factory default, 1s later, press exit button, hold it for 10 seconds, release it until hear three beeps and the LED in a short Green then turns in Red, means clear data successfully.

## Sound and Light Indication

Status	Light color	Buzzer
Standby	Red	—
Enter Programming	Red Shine Slowly	Beep—
Operation error and clear device	—	3 Beeps
Open lock	Green	Beep—